



Assembly and Installation Instructions for Model's

20180WV

CAUTION - RISK OF FIRE

Installation of this fixture should be done by a licensed electrician or by a person familiar with local electrical codes and the construction and operation of this fixture.

Warning please make sure the electrical breaker is shut off before commencing with this installation

Package Contents		
Part	Description	
A	Mounting bracket	1
B	Mounting bracket screws	2
C	Electrical connectors	3
D	Back plate	1
E	Wall bracket	1
F	Wall anchors	2
G	Wall anchor screws	2
H	Washer	1
I	Nut	1
J	Fixture assembly	1
K	Fixture mounting screws	4

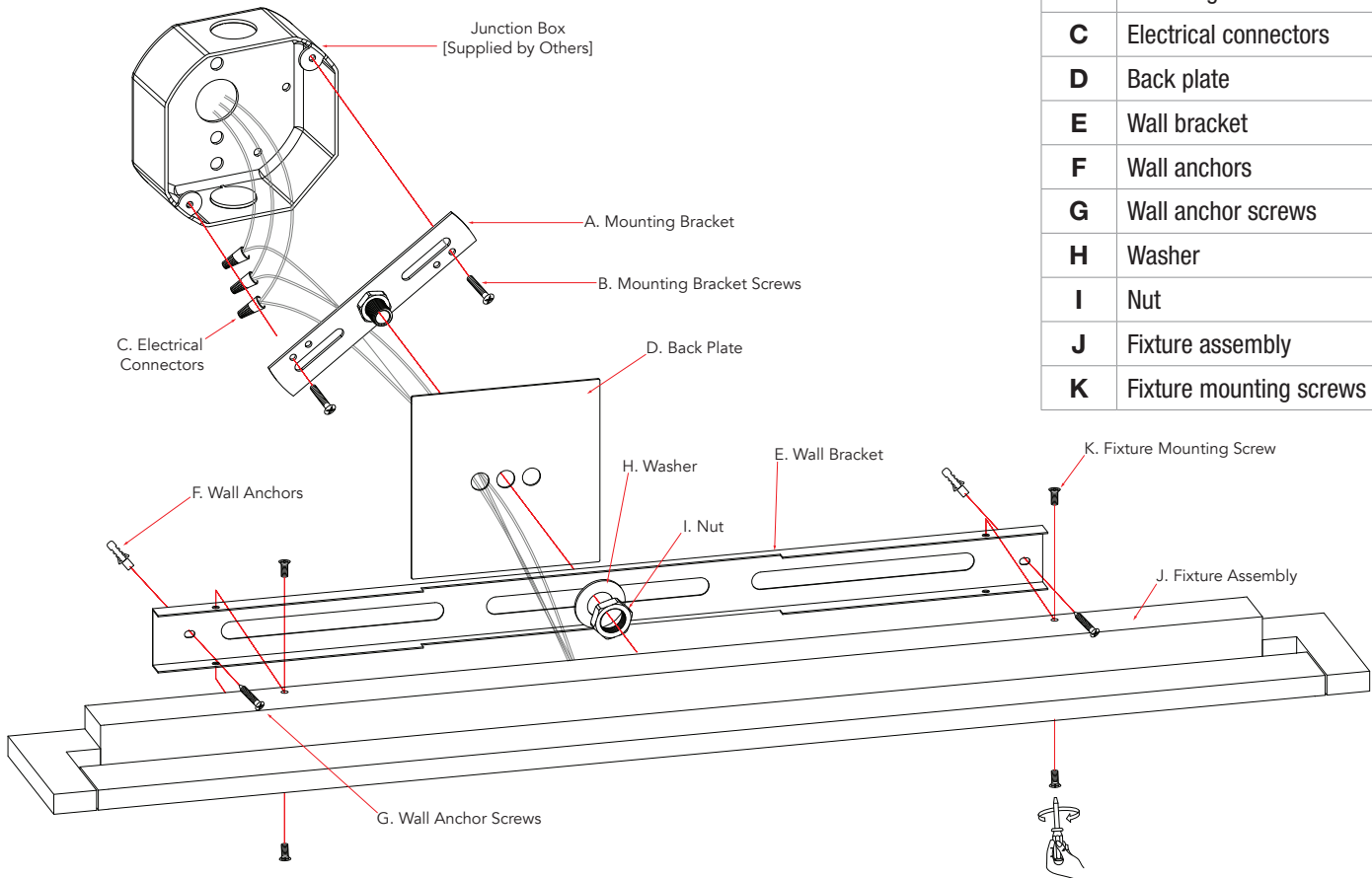

Installing the fixture

please ensure the electrical breaker is in the Off position before commencing

- 1 Attach the Mounting bracket (A) to the Junction Box [Supplied by Others] using the Mounting bracket screws (B)
- 2 Connect the supply wires to the fixture wires using the supplied electrical wire connectors (C). White supply wire to the White fixture wire, Black supply wire to Black fixture wire and the ground Bare Copper or Green wire to the Green fixture wire. Once the electrical wire connectors are securely fastened it is recommended to tape these connectors with electrical tape.
- 3 Loosely attach the Wall bracket (E) and Back plate (D) to the Mounting bracket (A) using the Nut (I) and mark where the Wall anchors (F) will be placed into the wall. Remove the Mounting bracket.
- 4 Insert the Wall anchors (F) into their marked spots and attach the Back plate (D) and Wall bracket (E) to the Mounting bracket (A) using the Washer (H) and Nut (I). Secure the Wall bracket to the wall by inserting the Wall anchor screws (G) into the Wall anchors.
- 5 Secure the Fixture assembly (J) to the Wall bracket (E) using the Fixture mounting screws (K) provided.
- 6 Switch on the electrical breaker switch and your new fixture is ready for many years of trouble free use.